

## PRODUCT INFORMATION

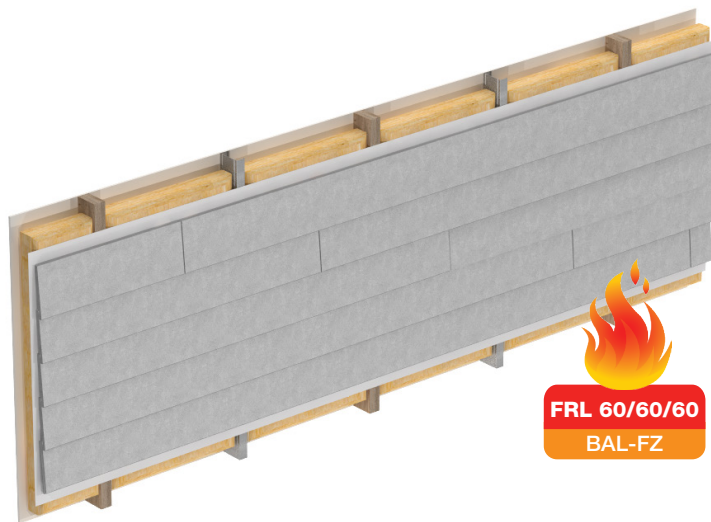

**INEX > WEATHERBOARD** is a revolutionary, low carbon, high strength, yet lightweight cement based exterior wall cladding suitable for both residential and commercial applications.

The long edges of **INEX > WEATHERBOARD** are precisely profiled to allow for easy installation and accurate overlaps, thus resulting in stunningly self-aligned horizontal lines that appeal to many designers.

**INEX > WEATHERBOARD** has a tongue and groove joint down each short end for a flush tight fit and off stud jointing.

The smooth side of **INEX > WEATHERBOARD** is an ideal surface for multiple paint applications.

**For all applications,  
INEX > WEATHERBOARD must be sealed and coated.**

PRODUCT	LENGTH(mm)	WIDTH(mm)	COVERAGE(mm)	THICKNESS(mm)	kg/m <sup>2</sup>	kg/Length
INEX > WEATHERBOARD 190	3000	190	160	16	22.0	12.5

### ADVANTAGES:

- **INEX > WEATHERBOARD** is lightweight and its self-alignment allows one man installation on site.
- **INEX > WEATHERBOARD** can be cut and worked just like other comparable fibre cement weatherboard, but offers improved bending strength characteristics and finish quality.
- **INEX > WEATHERBOARD** can be fixed to timber or steel studs with spacing at maximum 600mm centres.
- **INEX > WEATHERBOARD** is non-combustible. It is approved for bushfire BAL-FZ construction and is certified to Fire Resistance Level of FRL 60/60/60.
- **INEX > WEATHERBOARD** on a timber or steel frame with R2.5 insulation and 10mm plasterboard internal lining will deliver a sound insulation value of >Rw42, which will satisfy Category 2 of Transport Noise Corridors for external all requirements. Systems to achieve all Categories of Transport Noise Corridors available on application.
- **INEX > WEATHERBOARD** is an advanced high strength, low carbon fibre reinforced Engineered Cementitious Composite (ECC) product, containing about 40% of the embodied energy of equivalent portland cement derived products, containing 60% of post industrial recycled materials. It is 100% recyclable.
- **INEX > WEATHERBOARD** remains dimensionally stable as a wall cladding material.
- **INEX > WEATHERBOARD** is priced for value for the construction industry and competes strongly against all comparable products. Pricing is available on application to UBIQ or its distributors.
- **INEX > WEATHERBOARD** is resistant to mould and termite attack and does not contain any toxins and is asbestos free.
- **INEX > WEATHERBOARD** is water resistant, but at all times requires an approved coating system to be applied.
- **INEX > WEATHERBOARD** is long-term durable and is warranted for 20 years.



**Achieves FRL 60/60/60 when tested to AS 1530.4-2005  
Meets AS 3959-2009 Section 9 (BAL-FZ) via testing to AS 1530.4-2005**



**INEXWEATHERBOARD** painted finish.



**INEXWEATHERBOARD** clear coat finish.

**IMPORTANT NOTE: INEXWEATHERBOARD with a CLEAR FINISH**

Whilst **INEXWEATHERBOARD** is primarily used as a cladding product for a painted finish, it can also be treated with a suggested clear finish to retain its raw concrete appearance. Market response to this has become significant, however as **INEXWEATHERBOARD** is manufactured from a range of recycled raw materials it can vary in surface finish and colour. To ensure customer satisfaction should a clear finish be specified or wanted it needs to be understood that a greater level of care of; product selection, handling, fixing and application of the clear coat system is required. In this regard UBIQ has published a specific document to assist specifiers and installers to achieve the best outcome for **INEXWEATHERBOARD** with a clear finish. This document – '**INEXWEATHERBOARD** Clear Coat Finish' is available in the 'COATINGS' section of our website. Please read this document carefully and if you have any further questions please contact UBIQ.

Due to the cementitious nature of **INEXBOARDS** some superficial pin holing may occur.  
The smooth side of **INEXWEATHERBOARD** is characterised as a CLASS 2 concrete finish.

**COATING WARRANTY**

1. Common installation errors that will void your warranty include, but are not limited to: failing to properly seal screw holes and incorrect distance between studs. UBIQ does not provide warranty for any recommended coating systems for **INEXWEATHERBOARD**.
2. The purchaser must contact the coating suppliers for warranty purposes. The purchaser accepts all risk associated with performance of any coatings applied to **INEXWEATHERBOARD**. UBIQ recommends the coatings are tested prior to installation.