

INEX > EXPRESS™

TIMBER OR STEEL FRAME WITH VERTICAL SHEETS : FRL -/90/90

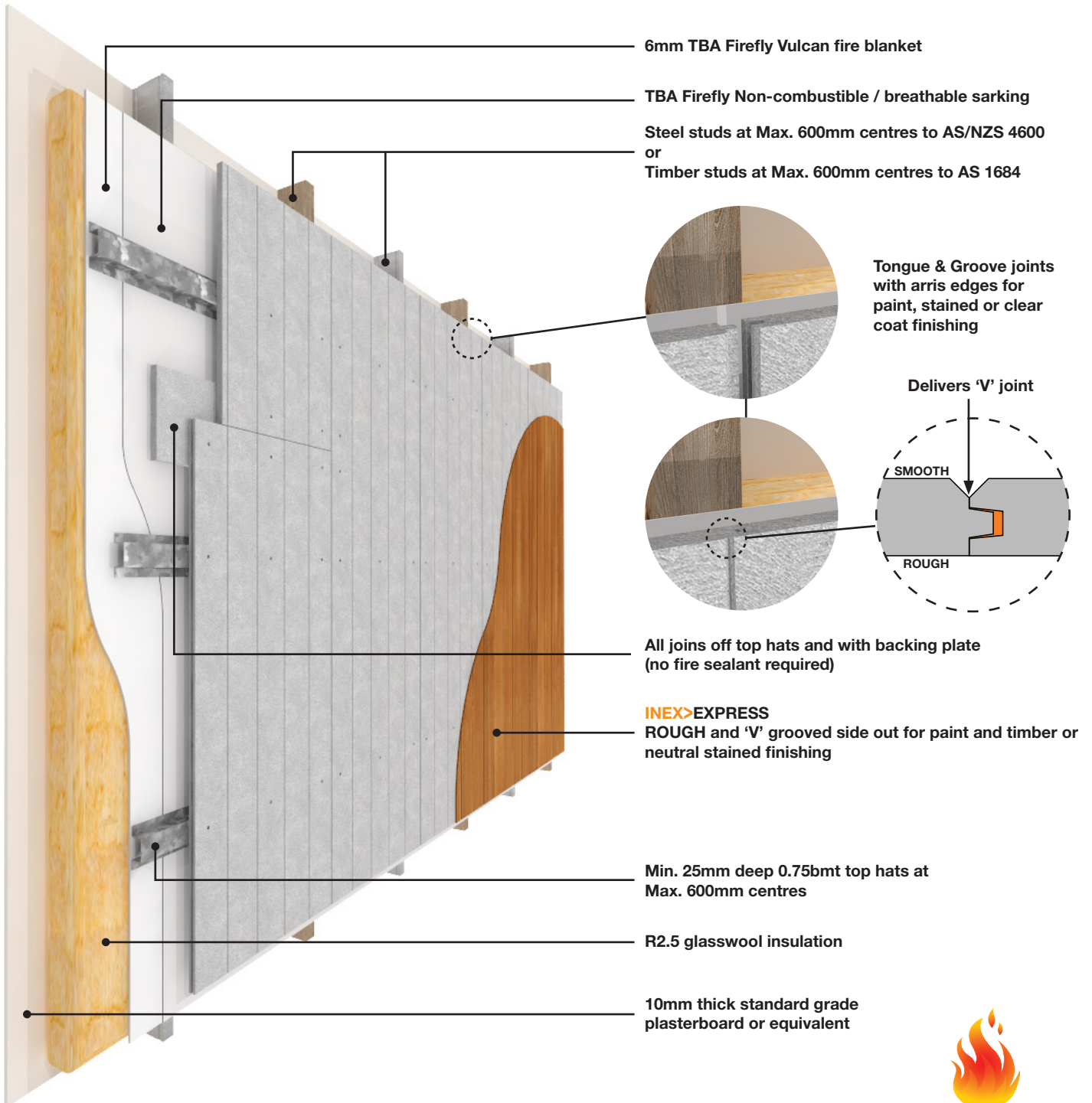

Achieves FRL -/90/90 from outside only when tested to AS 1530.4-2005



INEX > BOARDS™

ANY BUILDING • ANY SURFACE • ANYWHERE

INEX>EXPRESS™

TIMBER OR STEEL FRAME WITH VERTICAL SHEETS : FRL -/90/90

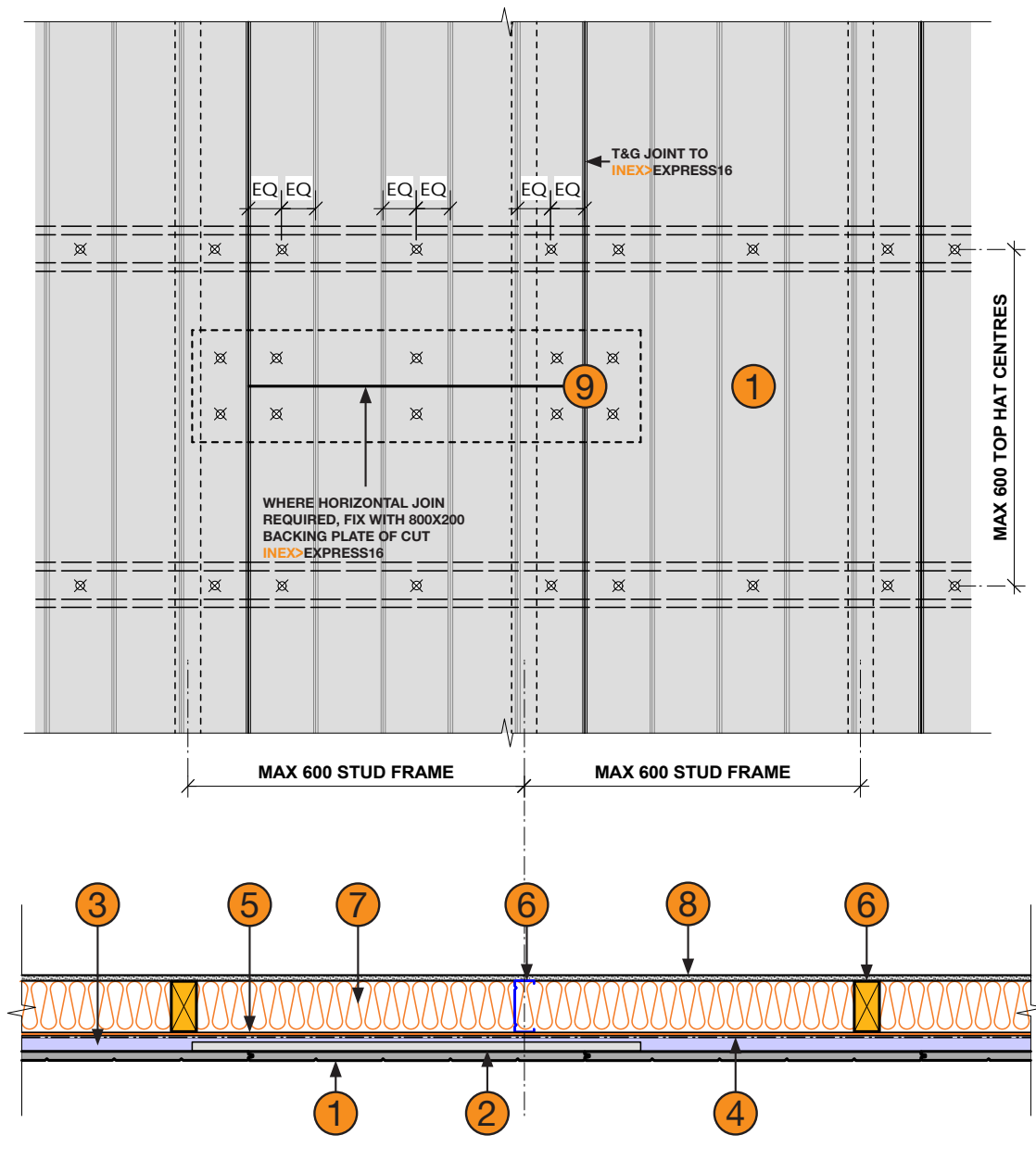

- | | |
|---|---|
| <ul style="list-style-type: none"> 1 INEX>EXPRESS16 2 800x200 Backing plate (Cut from INEX>BOARDS) 3 Min. 25mm deep 0.75bmt top hats at Max. 600mm centres 4 TBA Firefly Non-combustible / breathable sarking 5 6mm TBA Firefly Vulcan fire blanket | <ul style="list-style-type: none"> 6 Steel studs at Max. 600mm centres to AS/NZS 4600 or Timber studs at Max. 600mm centres to AS 1684 (Both drawn) 7 R2.5 glasswool insulation 8 10mm thick standard grade plasterboard or equivalent 9 10g Min. class 3 galvanised self drill counter sinking screws
BREMICK SWRC3100352
or
BREMICK vortexfibre SURC3500302 |
|---|---|

NOTES

This external wall system supported by Exova Warringtonfire EWFA 55988700.1
Refer also to INEX>EXPRESS Technical Sheet for fixing details