

INEX>RENDERBOARD™

TIMBER OR STEEL FRAME WITH VERTICAL SHEETS : FRL -/90/90

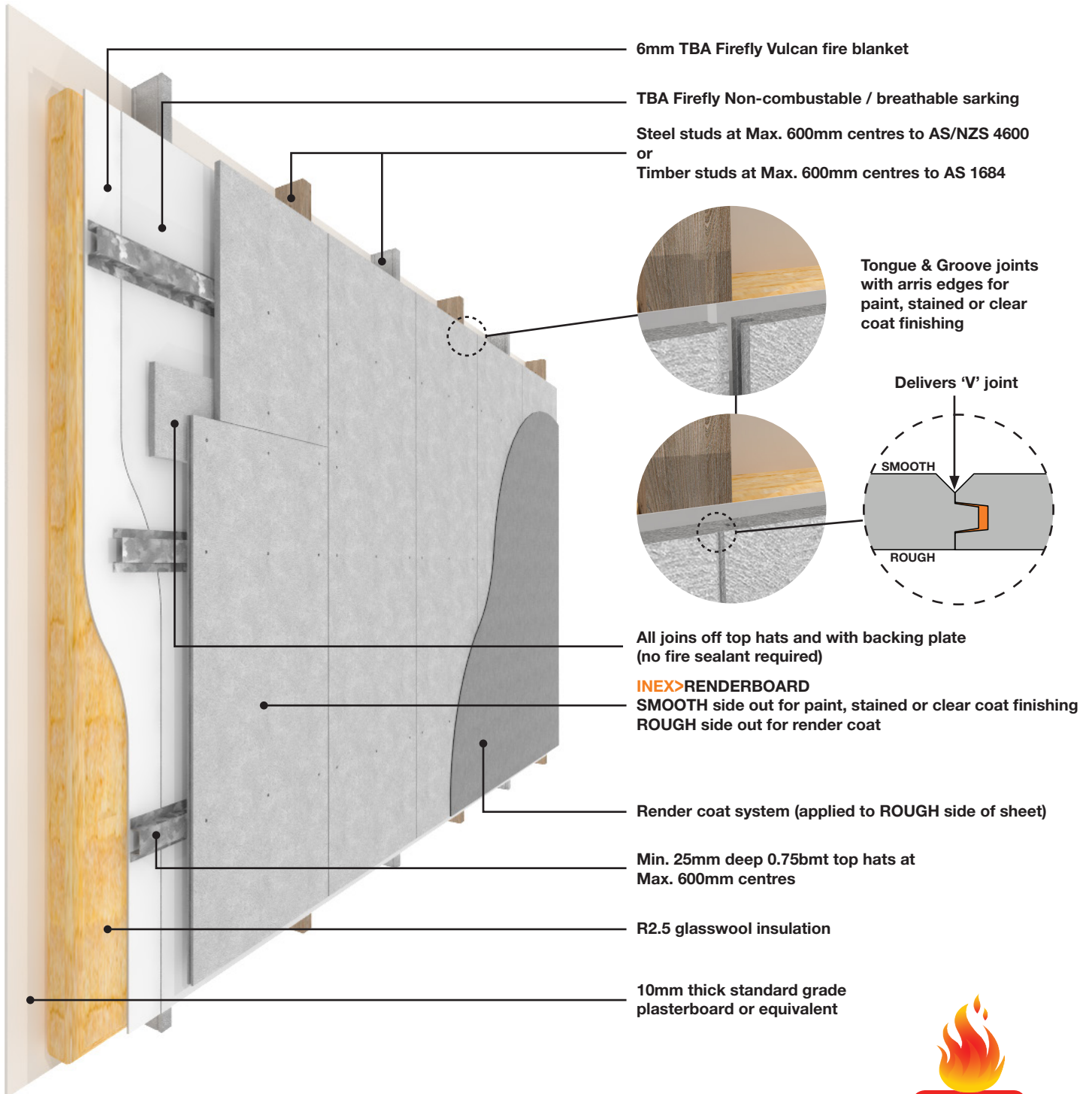

Achieves FRL -/90/90 from outside only when tested to AS 1530.4-2005



INEX>BOARDS™

ANY BUILDING • ANY SURFACE • ANYWHERE

INEX> RENDERBOARD™

TIMBER OR STEEL FRAME WITH VERTICAL SHEETS : FRL -/90/90

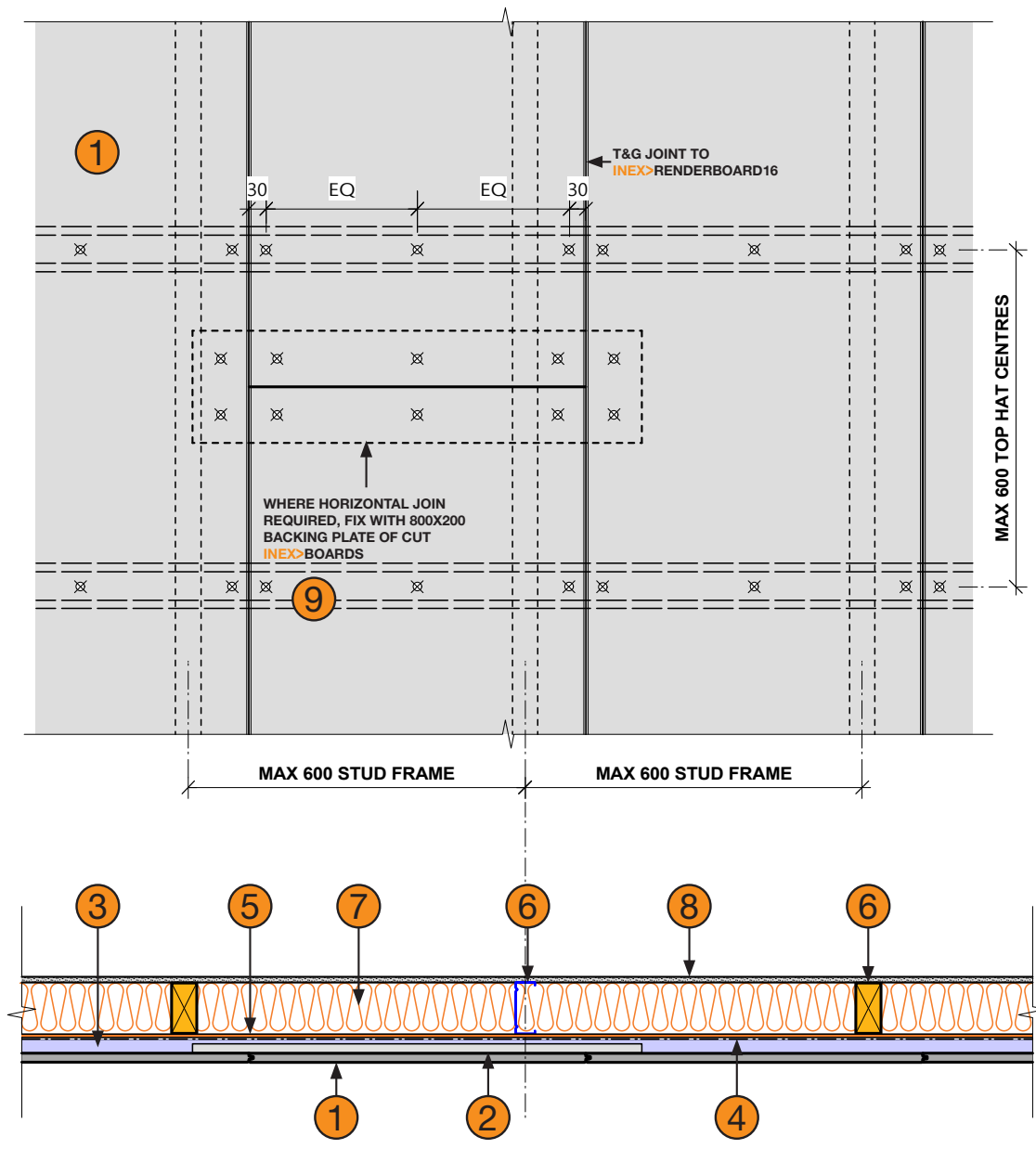

- | | |
|--|--|
| <p>1 INEX>RENDERBOARD16</p> <p>2 800x200 Backing plate (Cut from INEX>BOARDS)</p> <p>3 Min. 25mm deep 0.75bmt top hats at Max. 600mm centres</p> <p>4 TBA Firefly Non-combustable / breathable sarking</p> <p>5 6mm TBA Firefly Vulcan fire blanket</p> | <p>6 Steel studs at Max. 600mm centres to AS/NZS 4600 or Timber studs at Max. 600mm centres to AS 1684 (Both drawn)</p> <p>7 R2.5 glasswool insulation</p> <p>8 10mm thick standard grade plasterboard or equivalent</p> <p>9 10g Min. class 3 galvanised self driller counter sinking screws
BREMICK SWRC3100352
or
BREMICK vortexfibre SURC3500302</p> |
|--|--|

NOTES

This external wall system supported by Exova Warringtonfire EWFA *PENDING*
Refer also to INEX>RENDERBOARD Technical Sheet for fixing details