

INEX > EXPRESS™

TIMBER OR STEEL FRAME WITH HORIZONTAL SHEETS : FRL 60/60/60 & BAL-FZ

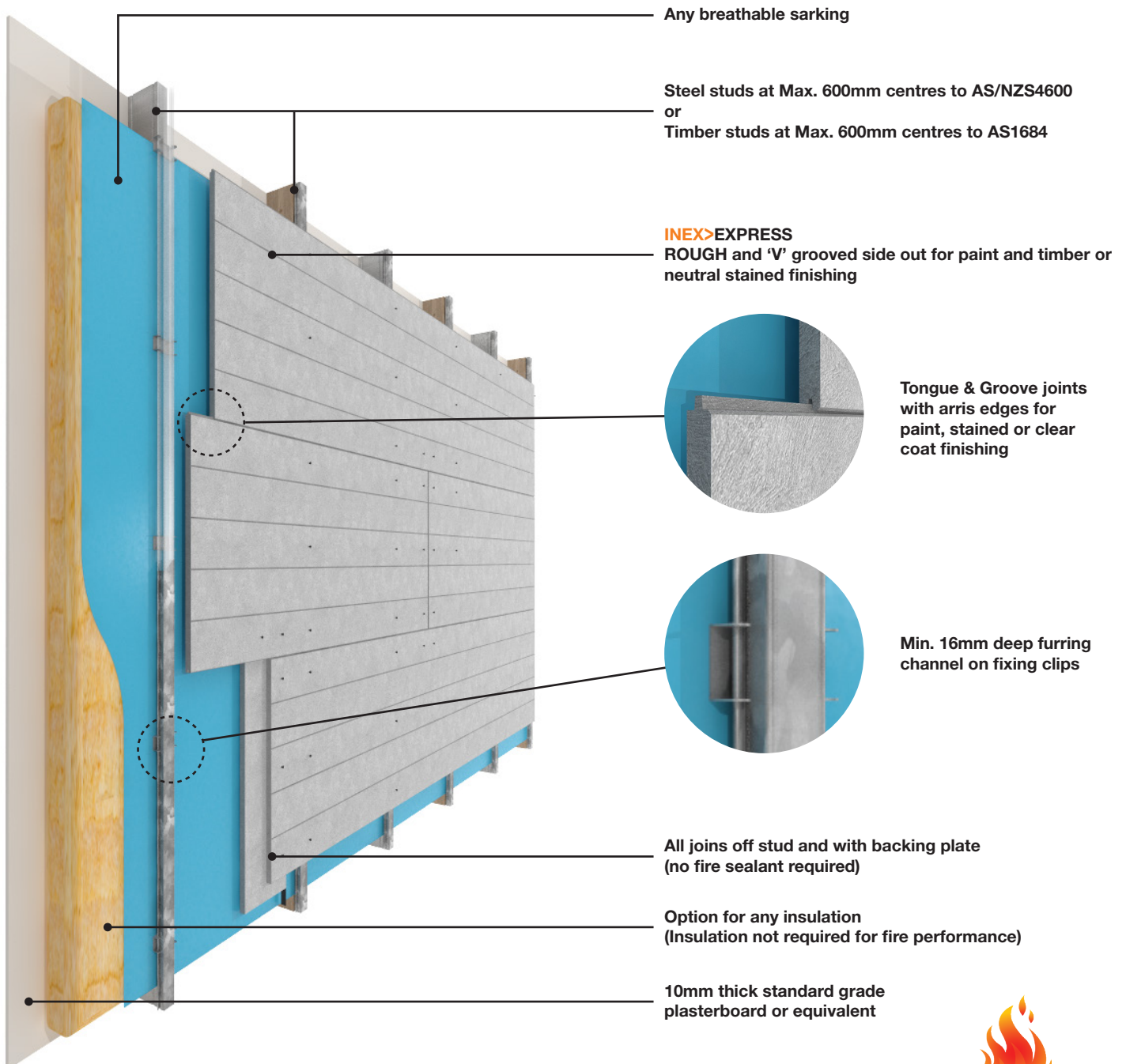

Achieves FRL 60/60/60 when tested to AS1530.4-2005
Meets AS3959-2009 Section 9 (BAL-FZ) via testing to AS1530.4-2005



INEX > BOARDS™

ANY BUILDING • ANY SURFACE • ANYWHERE

INEX>EXPRESS™

TIMBER OR STEEL FRAME WITH HORIZONTAL SHEETS : FRL 60/60/60 & BAL-FZ

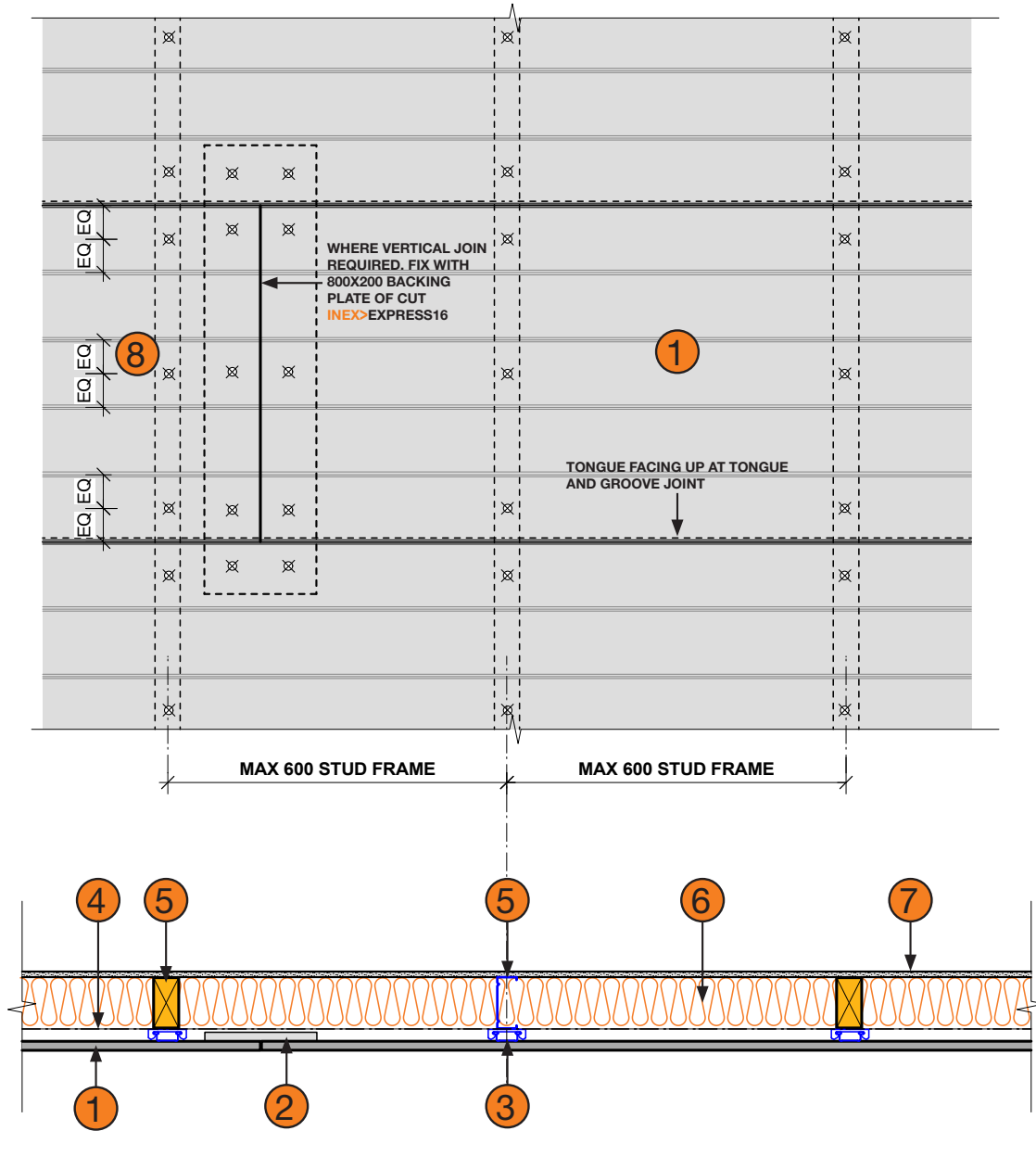

1 INEX>EXPRESS16

2 800x200 Backing plate (Cut from INEX>EXPRESS16)

3 Min. 16mm steel furring channel, on proprietary fixing clips

4 Any breathable sarking

NOTES

This external wall system supported by Exova Warringtonfire EWFA 19502800.6d and 27255600/RPT01-6d

Refer also to INEX>EXPRESS Technical Sheet for fixing details

5 Steel studs at Max. 600mm centres to AS/NZS4600 or Timber studs at Max. 600mm centres to AS1684 (Both drawn)

6 Any insulation (Insulation not required for fire performance)

7 10mm thick standard grade plasterboard or equivalent

8 10g Min. class 3 galvanised self driller counter sinking screws

BREMICK SWRC3100352 or BREMICK vortexfibre SURC3500302