

INEX>RENDERBOARD™

TIMBER OR STEEL FRAME WITH HORIZONTAL SHEETS : FRL 60/60/60 & BAL-FZ

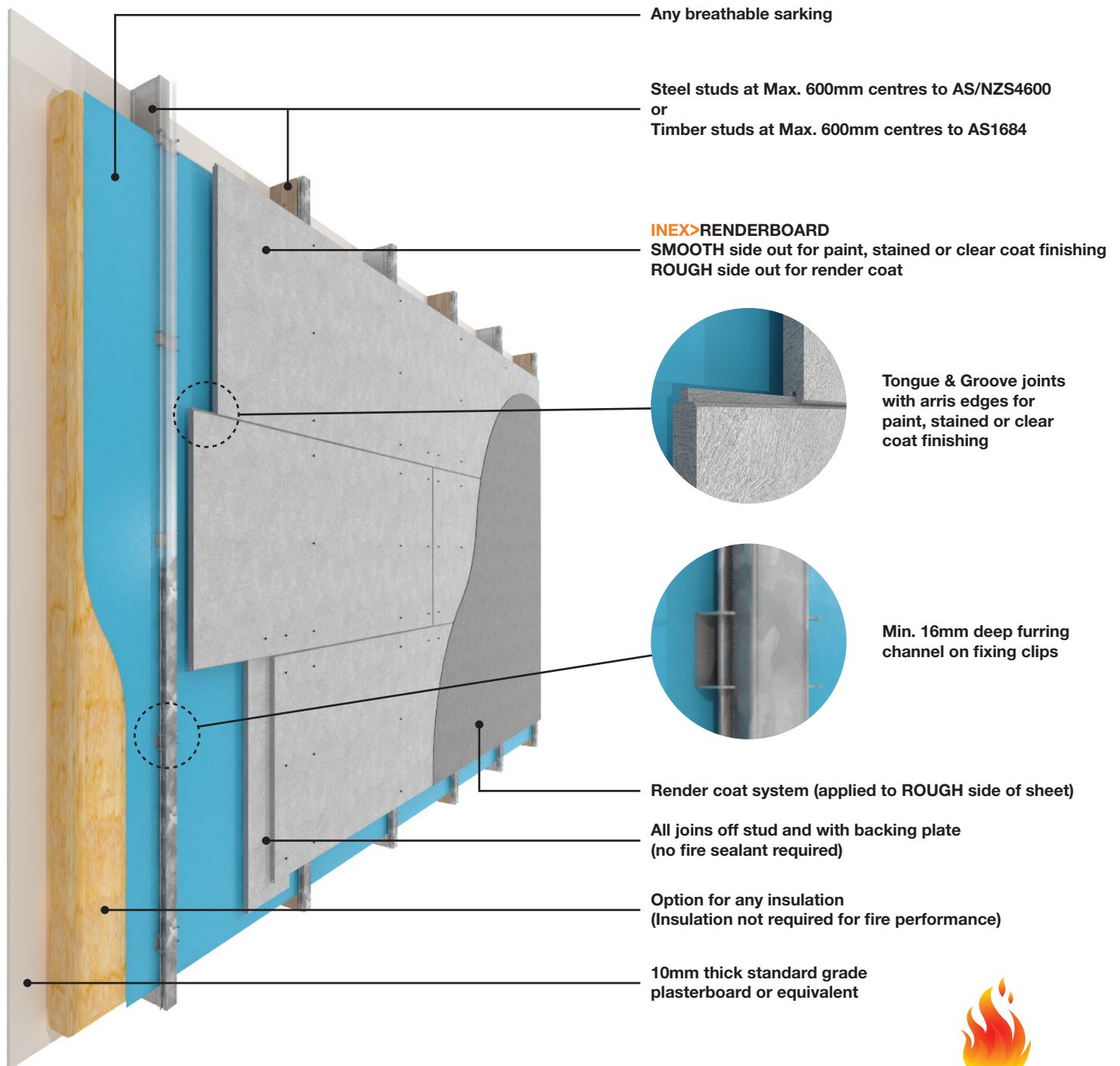

Achieves FRL 60/60/60 when tested to AS1530.4-2005
Meets AS3959-2009 Section 9 (BAL-FZ) via testing to AS1530.4-2005



INEX>BOARDS™

ANY BUILDING • ANY SURFACE • ANYWHERE

INEX> RENDERBOARD™

TIMBER OR STEEL FRAME WITH HORIZONTAL SHEETS : FRL 60/60/60 & BAL-FZ

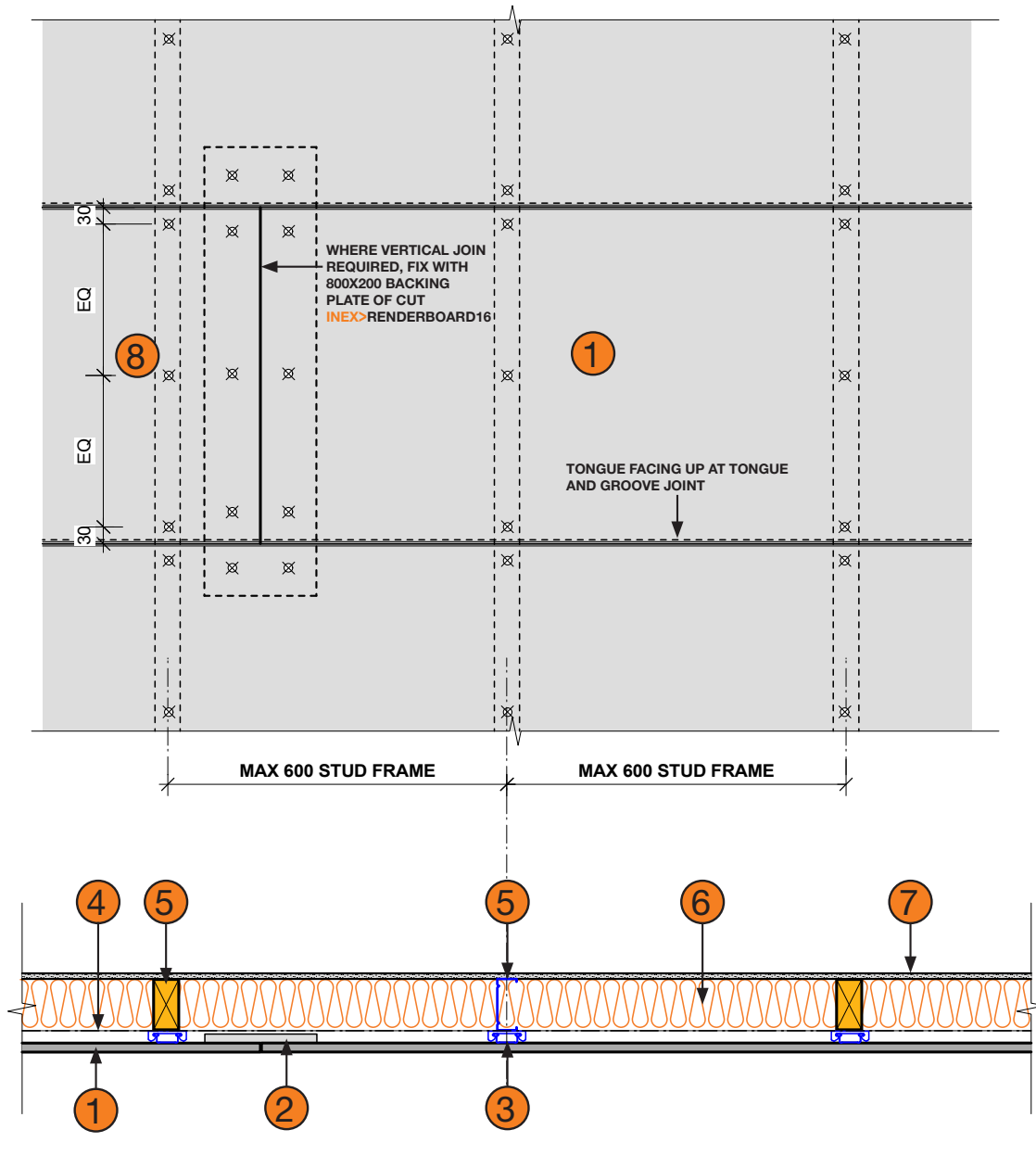

- | | |
|--|--|
| <p>1 INEX>RENDERBOARD16</p> <p>2 800x200 Backing plate (Cut from INEX>RENDERBOARD)</p> <p>3 Min. 16mm steel furring channel, on proprietary fixing clips</p> <p>4 Any breathable sarking</p> | <p>5 Steel studs at Max. 600mm centres to AS/NZS4600 or Timber studs at Max. 600mm centres to AS1684 (Both drawn)</p> <p>6 Any insulation (Insulation not required for fire performance)</p> <p>7 10mm thick standard grade plasterboard or equivalent</p> <p>8 10g Min. class 3 galvanised self driller counter sinking screws
BREMICK SWRC3100352
or
BREMICK vortexfibre SURC3500302</p> |
|--|--|

NOTES

This external wall system supported by Exova Warringtonfire EWFA 19502800.6b and 27255600/RPT01-6b
Refer also to INEX>RENDERBOARD Technical Sheet for fixing details