

INEX> RENDERBOARD™

TIMBER OR STEEL FRAME WITH VERTICAL SHEETS: FRL 60/60/60 & BAL-FZ
35mm DEEP TOP HATS

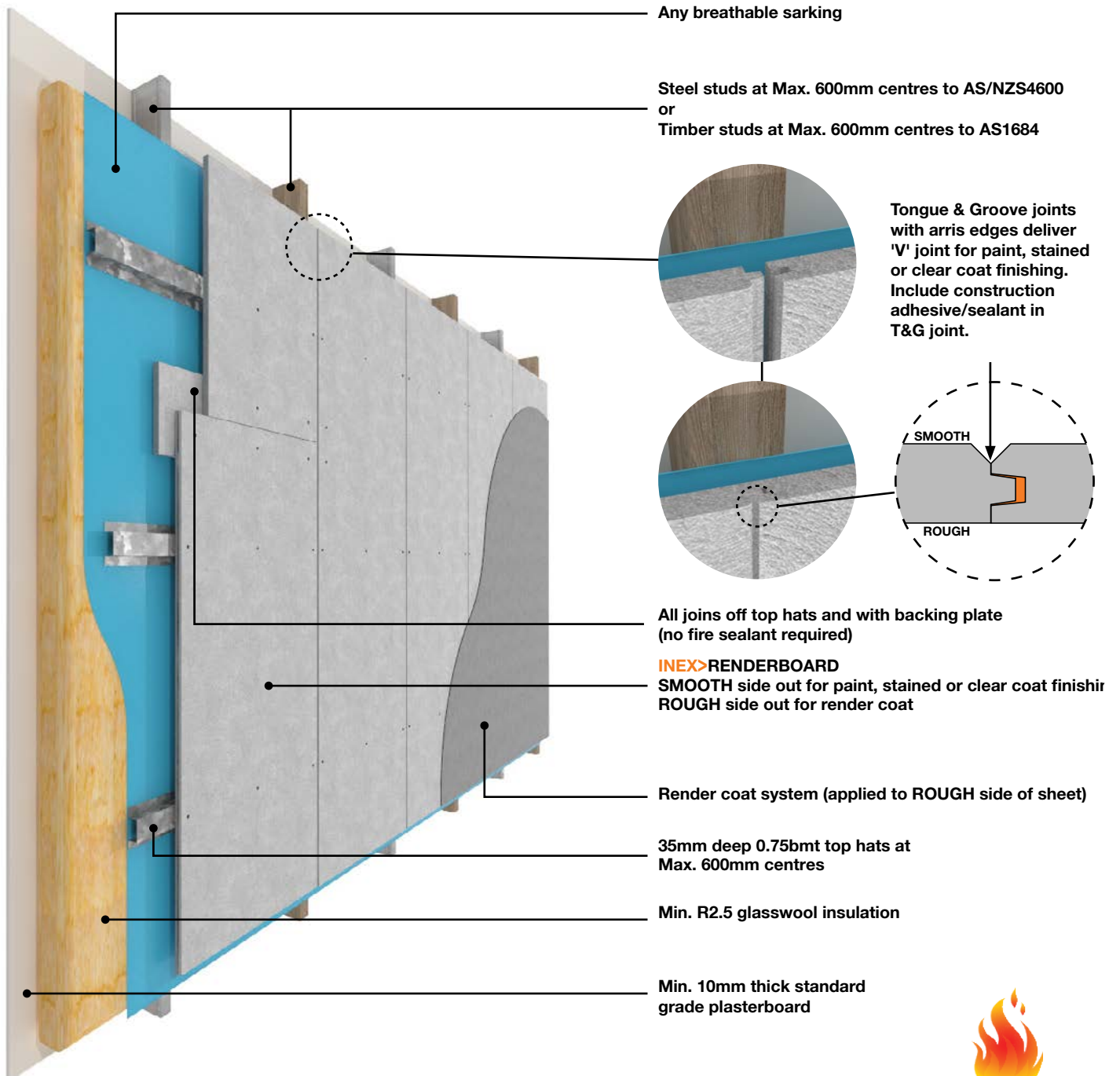

Achieves FRL 60/60/60 from outside only when tested to AS 1530.4-2014
Meets AS 3959-2018 Section 9 (BAL-FZ) via testing to AS 1530.4-2014



INEX>BOARDS™

ANY BUILDING • ANY SURFACE • ANYWHERE

INEX> RENDERBOARD^T

TIMBER OR STEEL FRAME WITH VERTICAL SHEETS: FRL 60/60/60 & BAL-FZ 35mm DEEP TOP HATS

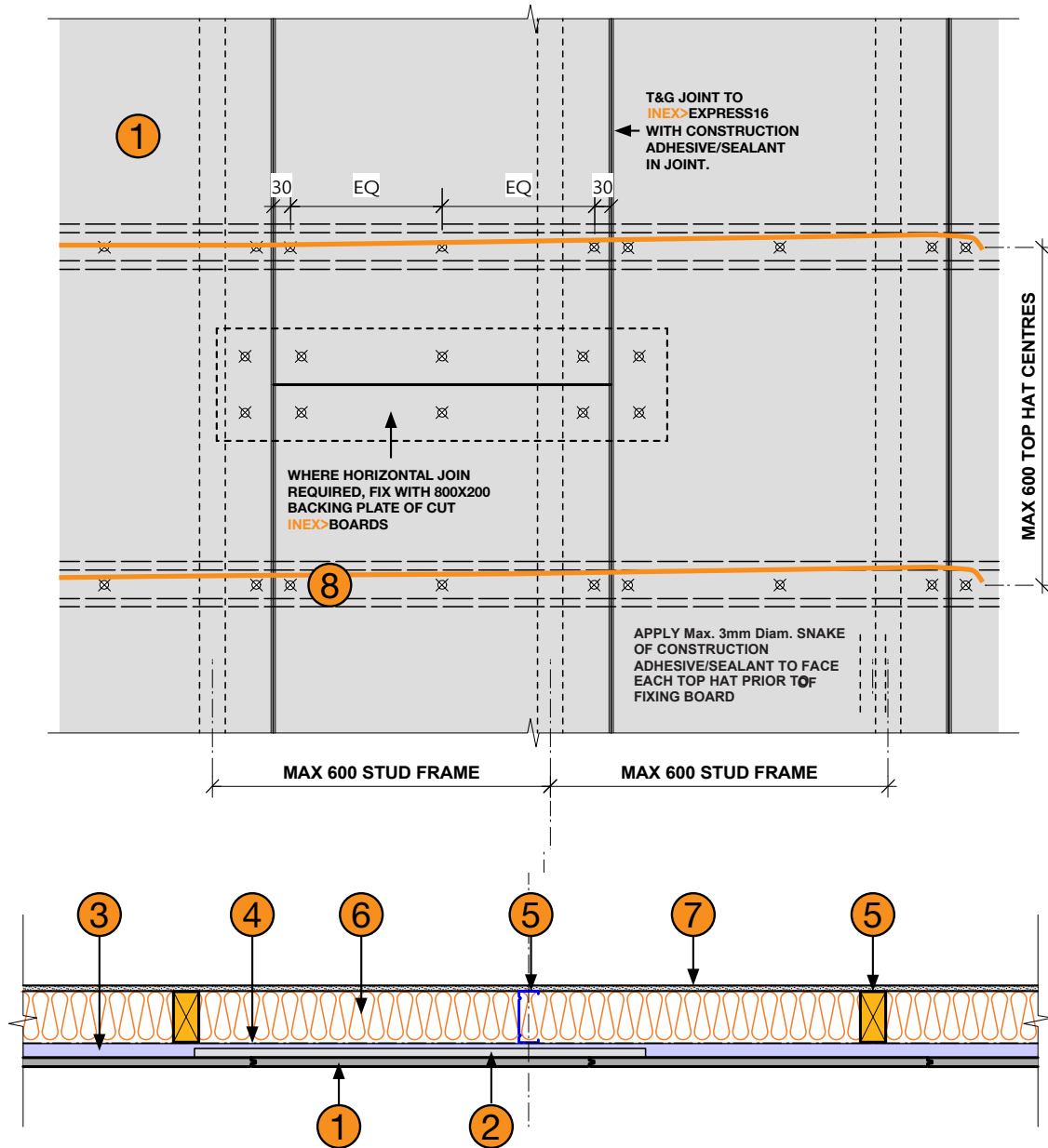

- | | |
|---|---|
| <p>1 INEX>RENDERBOARD16</p> <p>2 800x200 Backing plate (Cut from INEX>BOARDS)</p> <p>3 35mm deep 0.75bmt top hats at Max. 600mm centres</p> <p>4 Any breathable sarking</p> | <p>5 Steel studs at Max. 600mm centres to AS/NZS4600 or Timber studs at Max. 600mm centres to AS1684 (Both drawn)</p> <p>6 Min. R2.5 glasswool insulation</p> <p>7 10mm thick standard grade plasterboard</p> <p>8 10g Min. class 3 galvanised self driller counter sinking screws
BREMICK SWRC3100352
or
BREMICK vortexfibre SURC3500302</p> |
|---|---|
- NOTES**
Refer also to INEX>RENDERBOARD Technical Sheet for fixing details